

OHIO HISTORIC INVENTORY

JUN 27 1979

Ohio Historic Preservation Office
Ohio Historical Center
Columbus, Ohio 43211

1. No. 14

2. County
Summit

3. Location of Negatives
OHS

4. Present Name(s)
Lock No. 30 and Feeder Dam

5. Other Name(s)

6. Specific Location
on east side of Cuyahoga River approx. 0.25 mile north of Rt. 303

7. City or Town If Rural, Township & Vicinity
Peninsula

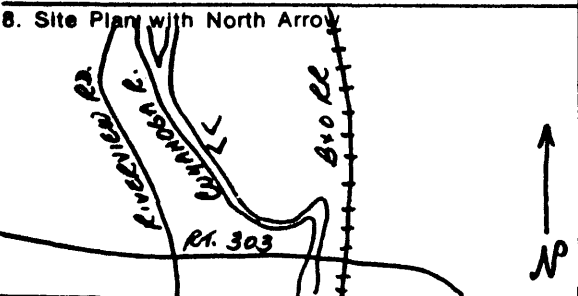

9. Coordinates

Lat. _____ Long _____

U.T.M. Reference _____

1	7	4	5	3	6	0	0	4	5	6	5	8	7	0
---	---	---	---	---	---	---	---	---	---	---	---	---	---	---

Zone _____ Easting _____ Northing _____

10. Site Structure
Building Object

11. On National Register? Yes No

12. Is It Eligible? Yes No

13. Part of Estab. Hist. Dist.? Yes No

14. District Potent'l? Yes No

15. Name of Established District

16. Thematic Category
F. H. I

17. Date(s) or Period
1825-1827

18. Style or Design

19. Architect or Engineer

20. Contractor or Builder

21. Original Use, if apparent
canal lock & feeder dam

22. Present Use
--

23. Ownership Public Private

24. Owner's Name & Address,
State of O., Dept. of Public Works
65 S. Front St., Columbus

25. Open to Public? Yes No
unrestricted

26. Local Contact Person or Organization
Summit County Hist. Soc.

27. Other Surveys in Which Included
included in "Ohio & Erie Canal historic civil engineering landmark, Ohio Council ASCE
Approx. Acreage: less than 1

28. No. of Stories

29. Basement? Yes No

30. Foundation Material

31. Wall Construction
load-bearing masonry

32. Roof Type & Material

33. No. of Bays Front _____ Side _____

34. Wall Treatment
cut stone/concrete

35. Plan Shape rectangle

36. Changes (Explain in #42) Addition Altered Moved

37. Condition fair
~~xxxx~~
~~xxxx~~

38. Preservation Underway? Yes No

39. Endangered? By What? Yes No

40. Visible from Public Road? Yes No

41. Distance from and Frontage on Road

42. Further Description of Important Features

Lock is standard mitered gate type. The lock chamber is 90 feet long by 15 feet wide. The cut sandstone construction was repaired with concrete c. 1905. Both gates are missing. There is water in the lock chamber. The remains of the feeder dam, also of cut stone, are adjacent to the canal lock.



43. History and Significance

One of two feeder dams on the Ohio & Erie Canal between Summit Lake and Cleveland (the other is at Lock No. 36). The dam was built across the Cuyahoga River to raise the water level sufficiently to allow a spillway to flow from the river to the canal and furnish the necessary water. The feeder dam ~~was destroyed by the flood of March 1913, as was virtually the entire canal~~

44. Description of Environment and Outbuildings

between Akron and Cleveland.
Located in a secluded area between the Cuyahoga River on the west and a steep hillside to the east. Accessible only on foot. There is wildlife present.

45. Sources of Information
Fred W. Bishop, "Feeder Lock," Greater Brecksville News, 9 March 1945.
Canal Society of Ohio, Towpaths, Sesquicentennial Issue No 1: 150 Years of Ohio's Canals, 1825-1975 (n.p., 1975) p.7.

46. Prepared by
Carol Poh Miller

47. Organization

48. Date
3/76

49. Revision Date(s)

Summit Lock No. 30 and Feeder Dam